

Hybrid Solar Inverter

S-2582/S2500 Series (8.2KW/10.2KW)



Features

- ▶ Pure sine wave solar inverter(on/off Grid)
- ▶ Output Power factor 1.0
- ▶ WIFI&GPRS available for IOS and Android
- ▶ Inverter can run without battery
- ▶ One-key restoration to factory Settings
- ▶ Built-in Lithium battery automatic activation
- ▶ Built-in 160A MPPT solar charger (for 8.2kw,10.2kw), 140A(for 7.2kw)
- ▶ High PV input voltage range(90~ 500VDC)
- ▶ Built-in anti-dust kit for harsh environment
- ▶ Smart battery charge design to optimize battery life
- ▶ Dual output
- ▶ Dual PV input
- ▶ Touch button
- ▶ On Off Grid Work Mode

Back panel printing description



Solar system connection

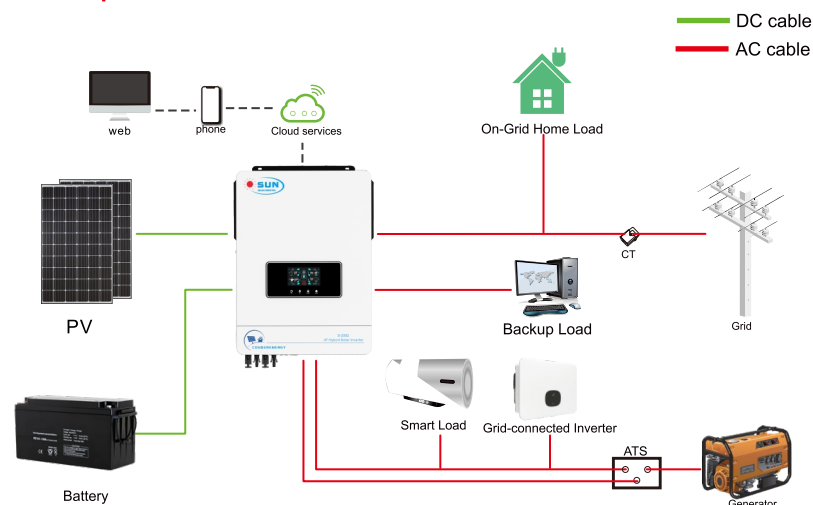

GRID OUTPUT (AC)			
Nominal Output Voltage	220/230/240VAC		
Output Voltage Range	190~253VDC		
Nominal Output Current	35.6A		44.3A
Power Factor	>0.99		
EFFICIENCY			
Maximum Conversion Efficiency (DC/AC)	98%		
TWO LOAD OUTPUT POWER			
Full Load	8200W		10200W
Maxium Main Load	8200W		10200W
Maxium Second Load(battery mode)	2733W		3400W
Maxium Load Cut Off Voltage	52VDC		52VDC
Maxium Load Return Voltage	54VDC		54VDC

OFF-GRID OPERATION			
AC INPUT			
AC Start-up Voltage / Auto Restart Voltage	120-140VAC/180VAC		
Acceptable Input Voltage Range	90-280VACor170-280VAC		
Frequency Range	49~51±1HZ		
Maximum AC Input Current	40A		50A
PV INPUT (DC)			
Nominal DC Voltage/Maximum DC Voltage	360/500VDC		
MPPT Voltage Range	90~450VDC		
Maximum Input Current	1/23A	2/18A	1/23A 2/18A

BATTERY MODE OUTPUT (AC)			
Nominal Output Voltage	220/230/240VAC		
Output Waveform	Pure sine wave		
Efficiency (DC to AC)	94%		
BATTERY & CHARGER			
Nominal DC Voltage	48VDC		
Maximum Solar Charging Current	160A		160A
Maximum AC Charging Current	140A		140A
Maximum Charging Current	160A		160A

HYBRID OPERATION			
PV INPUT (DC)			
Nominal DC Voltage/Maximum DC Voltage	360/500VDC		
Start-up Voltage / Initial Feeding Voltage	90VDC/120VDC		
MPPT Voltage Range	90~450VDC		
Maximum Input Current	1/23A	2/18A	1/23A 2/18A
GRID OUTPUT (AC)			
Nominal Output Voltage	220/230/240VAC		
Output Voltage Range	190~253VDC		
Nominal Output Current	35.6A		44.3A
AC INPUT			
AC Start-up Voltage / Auto Restart Voltage	120-140VAC/180VAC		
Acceptable Input Voltage Range	90-280VACor170-180VAC		
Maximum AC Input Current	40A		50A
Maximum AC Charging Current	140A		140A

GENERAL			
PHYSICAL			
Dimension, D x W x H (mm)	530*420*160		530*420*160
Carton Dimension, D X W XH(mm)	618*463*205		618*463*205
Net Weight (kgs)	14.6		15
Gross Weight(kgs)	16.1		16.5
INTERACE			
Communication Port	RS232/RS485/WIFI/GPRS/LITHIUM BATTERY		
ENVIRONMENT			
Humidity	5% to 95% Relative Humidity(Non - condensing)		
Operating Temperature	-10°C ~ 50°C		
STANDARD			
Compliance Safety	CE		

SPECIFICATION

MODEL	S-2582		S-2500	
Phase	1-phase			
Maximum PV Input Power	8200W	5400W+5400W	10200W	5400W+5400W
Rated Output Power	8200W/8200VA		10200W/10200VA	
Maximum Solar Charging Current	160A		160A	

GRID-TIE OPERATION				
PV INPUT (DC)				
Nominal DC Voltage/Maximum DC Voltage	360/500VDC			
Start-up Voltage / Initial Feeding Voltage	90VDC/120VDC			
MPPT Voltage Range	90~450VDC			
Maximum Input Current	1/23A	2/18A	1/23A	2/18A