

Hybrid Solar Inverter

S-2542/S2562 Series (4.2KW/6.2KW)



Features

- ▶ Pure sine wave solar inverter(on/off Grid)
- ▶ Output power factor 1.0
- ▶ WIFI&GPRS available for IOS and Android
- ▶ Inverter can run without battery
- ▶ One-key restoration to factory Settings
- ▶ Built-in Lithium battery automatic activation
- ▶ Dual communication ports for Battery communication and Wifi communication
- ▶ Built-in 120A MPPT Solar charge:max 6200W(for 4.2KW), max 6500W (for 6.2KW)
- ▶ High PV input voltage range(60~500VDC)
- ▶ Built-in anti-dust kit for harsh environment
- ▶ Smart battery charge design to optimize battery life
- ▶ Dual output

Back panel printing description

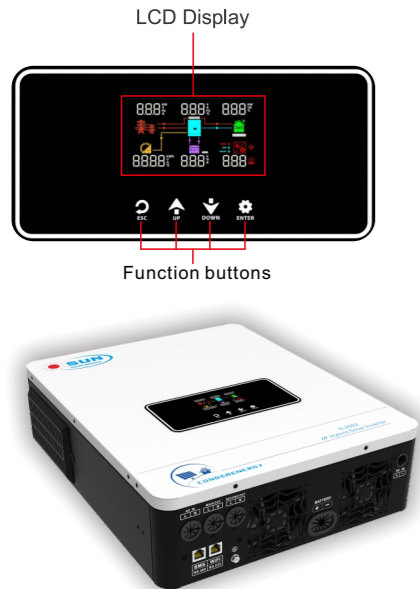

Solar system connection

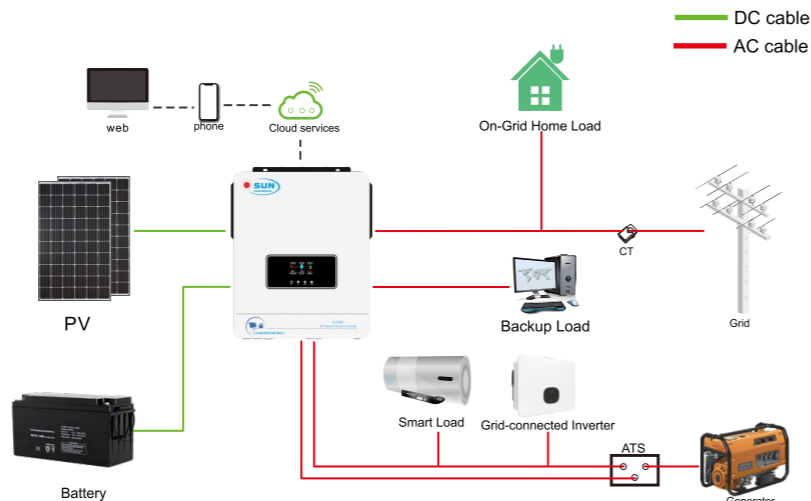

SPECIFICATION

MODEL	S-2542	S-2562
Phase	1-phase	
Maximum PV Input Power	6200W	6500W
Rated Output Power	4200W/4200VA	6200W/6200VA
Maximum Solar Charging Current	120A	
GRID-TIE OPERATION		
PV INPUT (DC)		
Nominal DC Voltage/Maximum DC Voltage	360/500VDC	
Start-up Voltage / Initial Feeding Voltage	60VDC/90VDC	
MPPT Voltage Range	60~450VDC	
Maximum Input Current	1/18A	1/22A

GRID OUTPUT (AC)

Nominal Output Voltage	220/230/240VAC	
Output Voltage Range	195.5~253VAC	
Nominal Output Current	18.2A	27.0A
Power Factor	>0.99	
EFFICIENCY		
Maximum Conversion Efficiency (DC/AC)	98%	
TWO LOAD OUTPUT POWER		
Full Load	4200W	6200W
Maxium Main Load	4200W	6200W
Maxium Second Load(battery mode)	1400W	2067W
Maxium Load Cut Off Voltage	26VDC	52VDC
Maxium Load Return Voltage	27VDC	54VDC

OFF-GRID OPERATION

AC INPUT		
AC Start-up Voltage / Auto Restart Voltage	120-140VAC/180VAC	
Acceptable Input Voltage Range	90-280VAC or 170-280VAC	
Frequency Range	49~51±1HZ	
Maximum AC Input Current	30A	40A
PV INPUT (DC)		
Nominal DC Voltage/Maximum DC Voltage	360/500VDC	
MPPT Voltage Range	60~450VDC	
Maximum Input Current	1/18A	1/22A
BATTERY MODE OUTPUT (AC)		
Nominal Output Voltage	220/230/240VAC	
Output Waveform	Pure sine wave	
Efficiency (DC to AC)	94%	
BATTERY & CHARGER		
Nominal DC Voltage	24VDC	48VDC
Maximum Solar Charging Current	140A	120A
Maximum AC Charging Current	100A	100A
Maximum Solar+AC Charging Current	140A	120A

HYBRID OPERATION

PV INPUT (DC)		
Nominal DC Voltage/Maximum DC Voltage	360/500VDC	
Start-up Voltage / Initial Feeding Voltage	90VDC/120VDC	
MPPT Voltage Range	60~450VDC	
Maximum Input Current	1/18A	1/22A
GRID OUTPUT (AC)		
Nominal Output Voltage	220/230/240VAC	
Output Voltage Range	195.5~253VAC	
Nominal Output Current	18.2A	27.0A
AC INPUT		
AC Start-up Voltage / Auto Restart Voltage	120-140VAC/180VAC	
Acceptable Input Voltage Range	90-280VAC or 170-280VAC	
Maximum AC Input Current	30A	40A
Maximum AC Charging Current	100A	

GENERAL

PHYSICAL		
Dimension, D x W x H (mm)	420*350*110	
Carton Dimension, D X W XH(mm)	500*415*180	
Net Weight (kgs)	8.0	8.9
Gross Weight(kgs)	9.0	10.0
INTERACE		
Communication Port	RS232/RS485/WIFI/GPRS/LITHIUM BATTERY	
ENVIRONMENT		
Humidity	5% to 95% Relative Humidity(Non ~ condensing)	
Operating Temperature	-10°C ~ 50°C	
STANDARD		
Compliance Safety	CE	